

Qty.	Description
------	-------------

1	MTA 60-180 A-W-A-B
---	--------------------



Note! Product picture may differ from actual product

Product No.: [97989221](#)

Low pressure immersible centrifugal pump for installation, in filtering systems or conveyer systems in the machine tool industry.

The pump has the following characteristics:

- The pump is closed-coupled without shaft seal.
- The pump is fitted with a 3-phase integrated motor.
- Open impeller allows particles to pass through pump
- Impeller is made of PAA GF50.
- Motor stool and pump housing are made of cast iron.
- The pump has no wearing parts.

Immersion depth: 180.5 mmm

Controls:

Frequency converter: Not prepared for VFD

Liquid:

Pumped liquid: Emulsion

Maximum liquid temperature: 60 °C

Selected liquid temperature: 20 °C

Density: 998.2 kg/m<sup>3</sup>

Technical:

Rated flow: 50 l/min

Rated head: 5.3 m

Max. Particle: 5 mm

Approvals: CE

Cable entry: 22

Materials:

Pump housing: Cast iron  
EN 1561 EN-GJL-200  
ASTM A48-25B

Impeller: PAA GF50

Installation:

Maximum ambient temperature: 40 °C

Pump outlet: G 3/4

Electrical data:

Power input P1: 200 W

Mains frequency: 50 Hz

Rated voltage: 3 x 220-240D/380-415Y V

Service factor: 1.15

Rated current: 0.69/0.42 A



Company name:

Created by:

Phone:

Date:

23/10/2024

Qty.	Description
------	-------------

1	Rated speed: 2932 rpm
	Motor efficiency at full load: 78.1 %
	Enclosure class (IEC 34-5): IP54
	Insulation class (IEC 85): F
	Built-in motor protection: N
	Others:
	Terminal box position: 9
	Net weight: 11.7 kg
	Gross weight: 13 kg
	Shipping volume: 0.027 m <sup>3</sup>
	Danish VVS No.: 386944118

Description	Value
<b>General information:</b>	
Product name:	MTA 60-180 A-W-A-B
Product No:	97989221
EAN number:	5710627481049
<b>Technical:</b>	
Rated flow:	50 l/min
Rated head:	5.3 m
Maximum head:	7.4 m
Max. Particle:	5 mm
Approvals:	CE
Pump version:	A
Model:	A
Cable entry:	22
<b>Materials:</b>	
Pump housing:	Cast iron
Pump housing:	EN 1561 EN-GJL-200
Pump housing:	ASTM A48-25B
Impeller:	PAA GF50
Material code:	A
<b>Installation:</b>	
Maximum ambient temperature:	40 °C
Pump outlet:	G 3/4
Connect code:	W
<b>Liquid:</b>	
Pumped liquid:	Emulsion
Maximum liquid temperature:	60 °C
Selected liquid temperature:	20 °C
Density:	998.2 kg/m <sup>3</sup>
<b>Electrical data:</b>	
Power input P1:	200 W
Mains frequency:	50 Hz
Rated voltage:	3 x 220-240D/380-415Y V
Service factor:	1.15
Rated current:	0.69/0.42 A
Rated speed:	2932 rpm
Motor efficiency at full load:	78.1 %
Enclosure class (IEC 34-5):	IP54
Insulation class (IEC 85):	F
Built-in motor protection:	N
<b>Controls:</b>	
Frequency converter:	Not prepared for VFD
<b>Others:</b>	
Terminal box position:	9
Net weight:	11.7 kg
Gross weight:	13 kg
Shipping volume:	0.027 m <sup>3</sup>
Danish VVS No.:	386944118

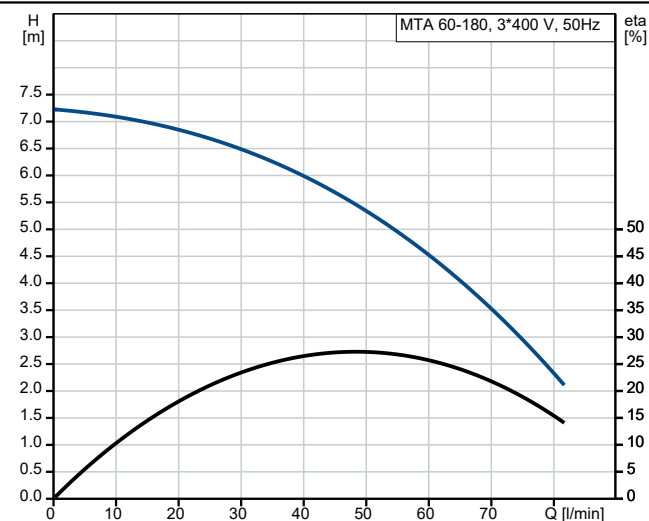

Pumped liquid = Emulsion  
Liquid temperature during operation = 20 °C  
Density = 998.2 kg/m<sup>3</sup>

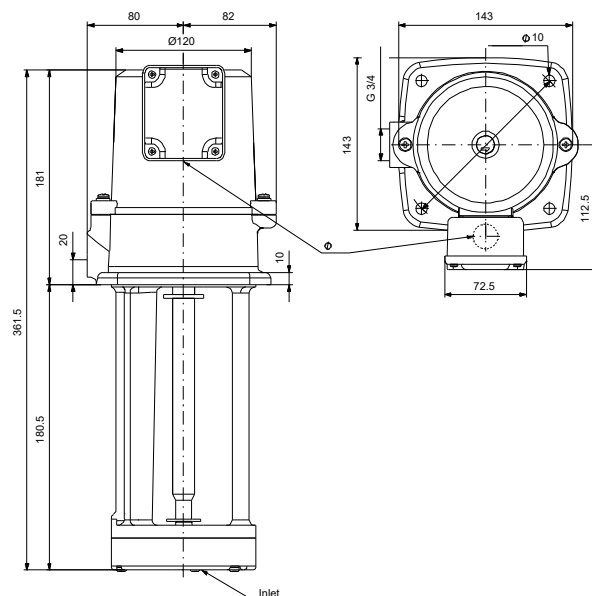
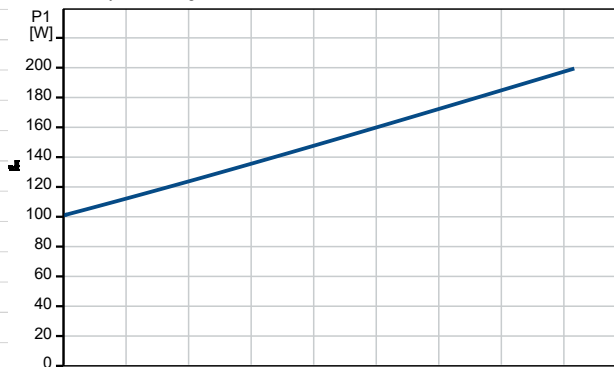

## 97989221 MTA 60-180 A-W-A-B 50 Hz

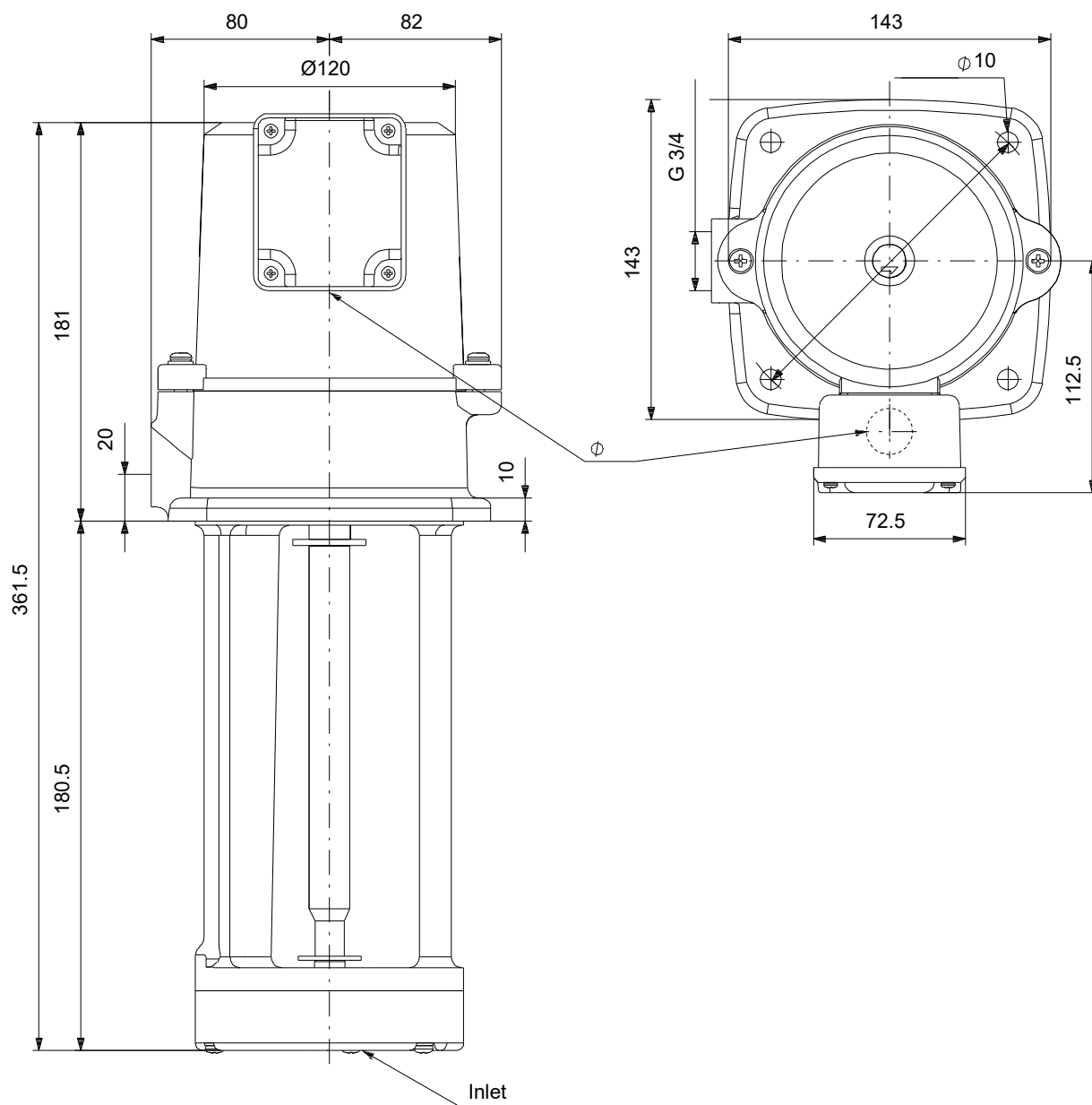

Note! All units are in [mm] unless others are stated.  
Disclaimer: This simplified dimensional drawing does not show all details.